

Benefits of your Cochlear Wireless Mini Microphone

Hear better over a distance and in noisy listening situations, such as:

- in meetings
- when travelling by car, bus or train
- dining at a restaurant
- participating in a class at the gym
- in schools and classrooms

How to:

Give the Mini Microphone to the person you want to listen to and ask them to position it close to their mouth by placing it on their clothing using the clip on the back. Then activate streaming on your Baha sound processor (see instructions below).

Tip! You can attach the Mini Microphone to your own shirt when having a conversation with a smaller group.

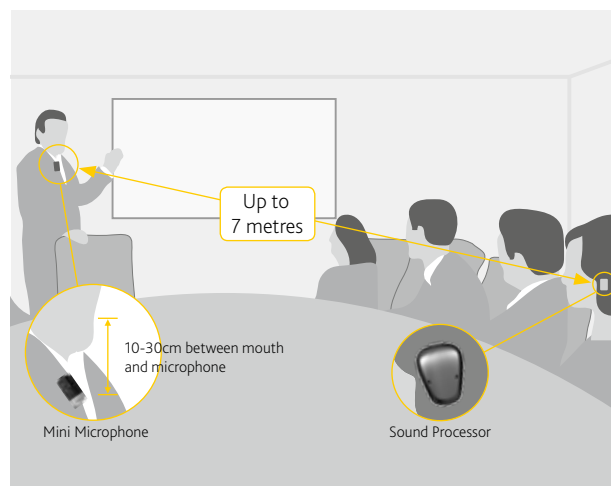

Hear the TV or radio better

How to:

Place the Mini Microphone by the TV speaker or radio. No need to plug it into a Head Phone outlet.



Stream audio to your sound processor

How to:

Insert one end of the supplied jack cable into the Mini Microphone's Line-in socket and the other end into the audio out of your audio device, such as a computer, MP3 player or hi-fi.



Product overview

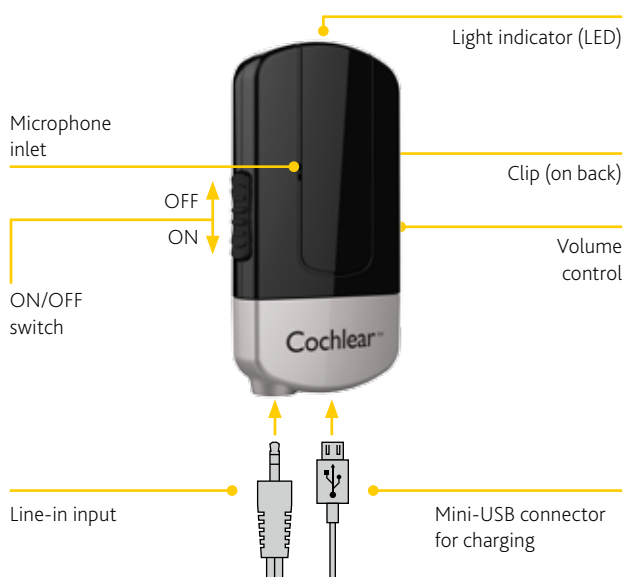

Getting Started

Check with your hearing healthcare professional whether your sound processor has been paired with your Mini Microphone. Pre-paired sound processors do not need to be paired again.

If your sound processor is not pre-paired, instructions on how to easily pair it with your Mini Microphone are on the last page of this guide.

Tip! Make sure that your sound processor volume is comfortably adjusted before you change the settings with the volume control on the Mini Microphone.

Charging the battery

Plug one end of the included mini-USB charging cable into the Mini Microphone and the other into a computer, or into a power outlet via the supplied adapter.

The first time you charge your Mini Microphone allow it to charge for at least 3 hours, even if the indicator light shows a full charge. The battery cannot be overcharged.

Note: The Mini Microphone will operate for up to 7,5 hours between charges.

Pairing with your Baha sound processor

- A** Switch off your Baha sound processor by opening the battery door.



- B** Switch on your Mini Microphone and remove the silver cap.

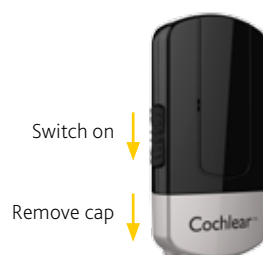

- C** Press the pairing button on the Mini Microphone once using the tip of a pen or similar object.



You can pair up to three Cochlear wireless accessories with your sound processor(s).

To pair a Mini Microphone in channel 2 press the pairing button twice. The LED will flash yellow twice every 2 seconds.

To pair a Mini Microphone in channel 3 press the pairing button 3 times. The LED will flash yellow 3 times every 2 seconds.

- D** The LED will flash yellow every 2 seconds and the Mini Microphone will now be in pairing mode for 20 seconds.



- E** While pairing mode is active, switch on your sound processor by closing the battery door.



- F** Successful pairing will be indicated by an audible melody played in the sound processor.



Using your Cochlear Wireless Mini Microphone

Listening to sound from the Mini Microphone

Make sure both your sound processor and Mini Microphone are switched on, then Press and hold the button (long press) on your sound processor until an audio melody is heard.



Listening to sound from a second and/or third Cochlear Wireless Accessory

If your sound processor is paired with more than one wireless accessory, you can toggle between the accessories in the different channels by pressing the button (long press) on your sound processor once, twice or three times, until you have selected the accessory you want.



How to stop listening to a streaming accessory

Press the button (short press) on the sound processor to return to your previous program.



Support

For full details about the Cochlear Wireless Mini Microphone, please refer to the User Manual.

For full details about the Cochlear Baha sound processor, please refer to the User Manual part A.

Manufacturer:

Cochlear Bone Anchored Solutions AB Konstruktionsvägen 14, 435 33 Mölnlycke, Sweden
Tel: +46 31 792 44 00 Fax: +46 31 792 46 95

www.cochlear.com

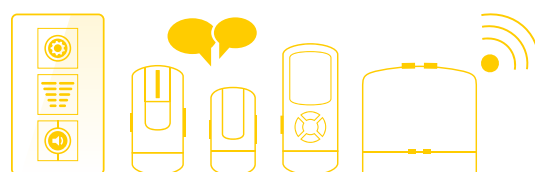

Visit www.cochlear.com to learn about our full range of apps and wireless accessories.