

COCHLEAR™ WIRELESS PHONE CLIP

POCKET GUIDE



Cochlear®

Welcome to True Wireless. **No Strings Attached.**

Index

- 3. Overview
- 4. Getting Started
- 5. Product Diagram
- 6. Pairing
- 10. Using

Visit us online for helpful tips,
how-to videos and more:

www.cochlear.com/us/N6wireless
recipients.mycochlear.com

The Cochlear™ Wireless Phone Clip allows you to:

- Enjoy hands-free calling direct to your CP900 Series Sound Processor.
- Hear your Bluetooth®-enabled navigation system.
- Stream music from a Bluetooth-enabled device.

How to:

The Phone Clip can be easily attached to clothing. The built-in microphone will pick up and transmit your voice, even if your phone is several meters away.

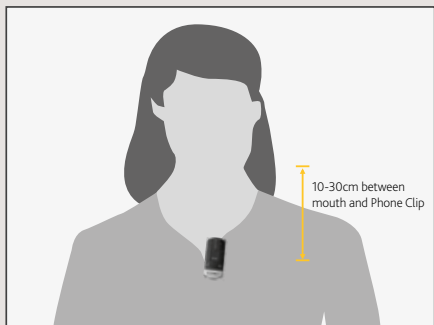

Getting Started

Charging the battery

Plug one end of the included micro-USB charging cable into the Phone Clip and the other into a computer, or into a power outlet via the supplied adapter.

When the red LED indicator on top of the Phone Clip turns green with a red blink every 2 seconds charging is complete.

Before you use your Phone Clip you should allow it to charge for at least 3 hours, even if the indicator light shows a full charge. The battery cannot be overcharged.

Note: *The Phone Clip provides 6 hours of talk time or 80 hours of standby time from a full charge.*

Product Diagram

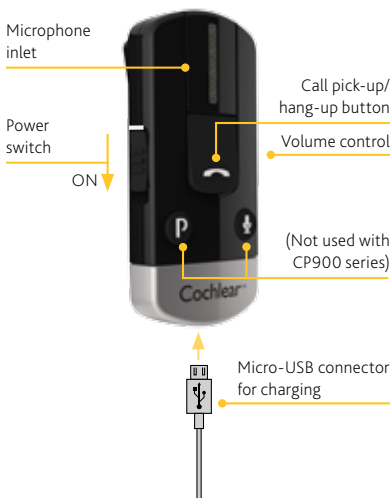

Pairing

Follow the four steps below to pair your Nucleus® 6 or Kanso™ Sound Processor to the Cochlear Wireless Phone Clip.

1 Switch off your CP900 Series Sound Processor.

Remove the Sound Processor from your ear. Disconnect the battery.

OR

Press and hold Kanso button until the light is a steady orange.

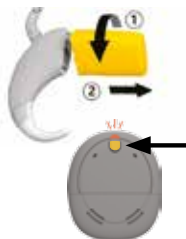

2 Switch on your Phone Clip and remove the silver cap.



- 3 Press the white pairing button on the Phone Clip once using the tip of a pen or similar object.

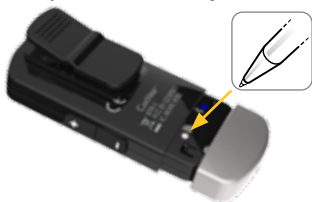

Note: The LED will flash yellow every 2 seconds and the Phone Clip will now be in pairing mode for 20 seconds.

- 4 While pairing mode is active (20 seconds), attach the battery to the Nucleus 6 Sound Processor (CP910/920) or Press the button on the Kanso Sound Processor (CP950) to turn on.



A blue indicator light flashes to show that pairing has been successful.

Have more than one Wireless Accessory?
Consult the User Guide to pair up to three devices to your sound processor(s).

Pairing with a Mobile Phone

Follow the six steps below to pair your the Cochlear Wireless Phone Clip with your mobile phone.

- 1 Switch on your Phone Clip and remove the silver cap.**



- 2 Make sure your mobile phone's Bluetooth function is switched on.**

Refer to your mobile phone user guide for instructions. Press the blue Bluetooth pairing button on the Phone Clip once to activate the pairing mode for 2 minutes.



- 3 During pairing mode the LED will turn blue.



- 4 On your mobile phone search for new Bluetooth devices and select "Hearing Aid Phone" from the list.
- 5 If your mobile phone asks for a passcode, enter "0000" (four zeros).
- 6 Your Phone Clip should now be paired with your mobile phone. If your mobile phone asks which Bluetooth service you wish to enable, select "Headset".

Tip!: In most instances, a headset symbol on the main screen of your mobile phone will confirm that you have successfully connected.

Using

Now that the Cochlear Wireless Phone Clip is paired you are ready to start using it.

Managing calls with the call pick-up / hang-up button



- **Incoming calls:**
 - To answer a call, press once.
 - To decline a call, double-click.
- **During a call:**
 - To transfer a call started on your phone to the phone clip, press once.
 - To put a call on hold, press and hold for 2 seconds.
- **To make a call:**
 - To redial the last number, double-click.
 - To activate voice dialling, press and hold for 2 seconds.

Stream music from your phone

You can use the Phone Clip to stream music from your mobile phone or computer.

- Connect the device to the Phone Clip using Bluetooth.
- Start playing music on the device.
- You hear the audio streaming from the device.
- To stop streaming, stop playing music on the device.



Tip!: To change the volume, use the volume controls on the Phone Clip.

Visit us online for helpful tips,
how-to videos and more:

www.Cochlear.com/US/N6wireless
recipients.mycochlear.com

www.Cochlear.com/US

Cochlear Americas

13059 East Peakview Avenue
Centennial, CO 80111 USA
Telephone: 1 303 790 9010
Support: 1 800 483 3123

Cochlear Canada Inc.

2500-120 Adelaide Street West
Toronto, ON M5H 1T1 Canada
Telephone: 1 416 972 5082
Fax: 1 416 972 5083



©Cochlear Limited 2014. All rights reserved.
Trademarks and registered trademarks are the
property of Cochlear Limited.

FUN2195 ISS3 OCT16